

User Manual

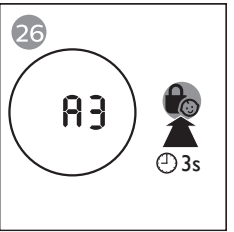

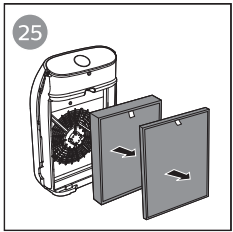
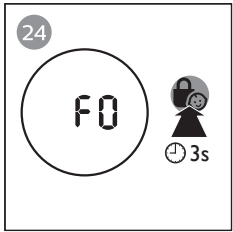
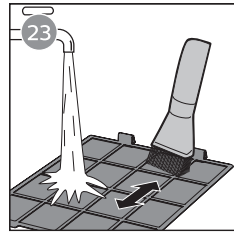
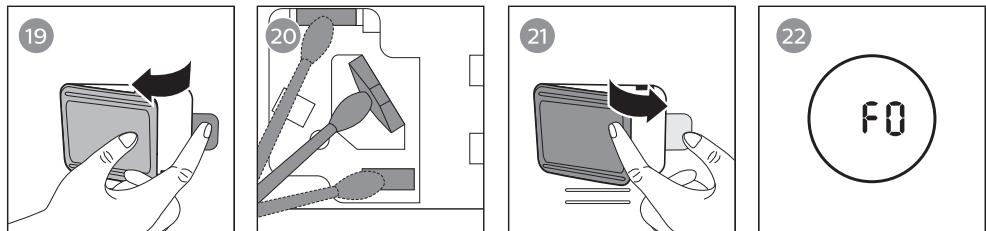
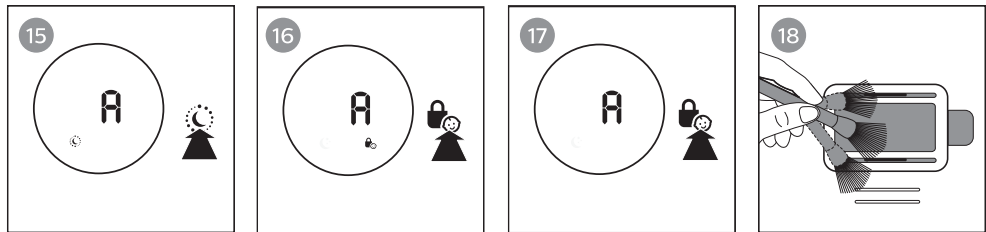
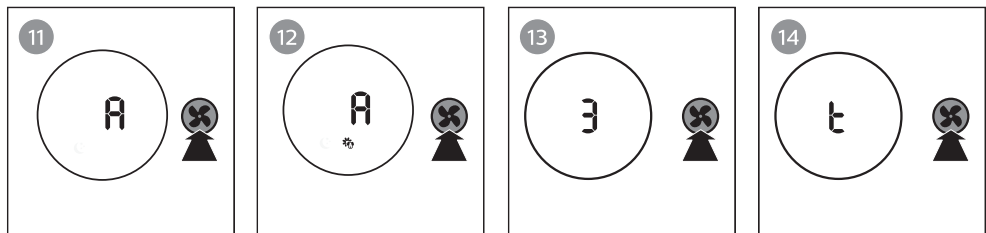
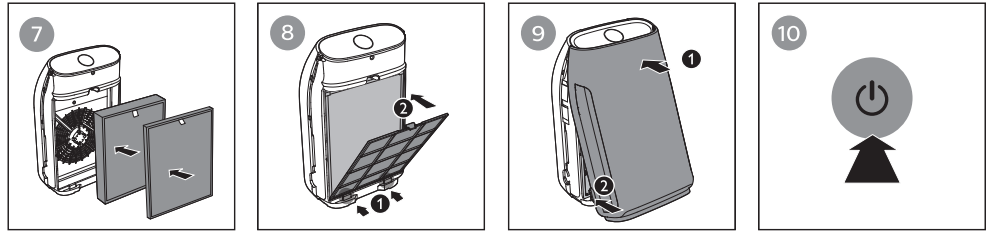
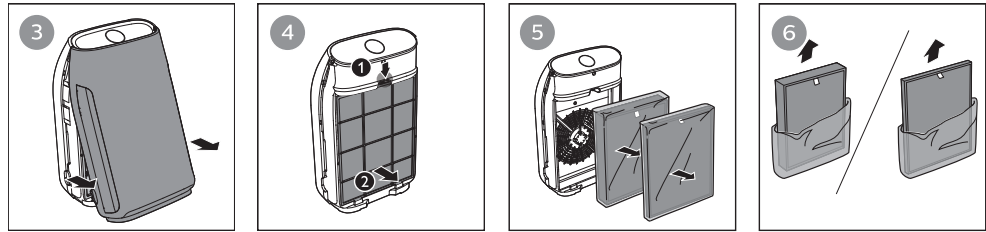

Contents

1 Important	2
2 Your air purifier	5
Product overview	5
Controls overview	5
3 Getting started	6
Installing the filter	6
4 Using the air purifier	6
Understanding the air quality light	6
Turning on and off	6
Changing the fan speed	7
Light sensor	7
Night sensing mode	8
Set the child lock	8
5 Cleaning	9
Cleaning the body of the air purifier	9
Cleaning the air quality sensor	9
Cleaning the pre-filter	10
6 Replacing the filter	11
Filter replacement indicator	11
Replacing the filters	11

7 Storage	12
8 Troubleshooting	13
9 Guarantee and service	15
Order parts or accessories	15
10 Notices	15
Electromagnetic fields (EMF)	15
Recycling	16

1 Important

Read this user manual carefully before you use the appliance, and save it for future reference.

Danger

- Do not let water or any other liquid or flammable detergent enter the appliance to avoid electric shock and/or a fire hazard.
- Do not clean the appliance with water, any other liquid, or a (flammable) detergent to avoid electric shock and/or a fire hazard.
- Do not spray any flammable materials such as insecticides or fragrance around the appliance.

Warning

- Check if the voltage indicated on the appliance corresponds to the local power voltage before you connect the appliance.
- If the power cord is damaged, you must have it replaced by Philips, a

service center authorized by Philips, or similarly qualified persons in order to avoid a hazard.

- Do not use the appliance if the plug, the power cord, or the appliance itself is damaged.
- This appliance can be used by children aged from 8 years and above and persons with reduced physical, sensory or mental capabilities or lack of experience and knowledge if they have been given supervision or instruction concerning use of the appliance in a safe way and understand the hazards involved. Child shall not play with the appliance. Cleaning and maintenance shall not be made by children without supervision.
- Do not block the air inlet and outlet, e.g. by placing items on the air outlet or in front of the air inlet.
- Make sure that foreign objects do not fall into the appliance through the air outlet.

Caution

- This appliance is not a substitute for proper ventilation, regular vacuum cleaning, or use of an extractor hood or fan while cooking.
- If the power socket used to power the appliance has poor connections, the plug of the appliance becomes hot. Make sure that you plug the appliance into a properly connected power socket.
- Always place and use the appliance on a dry, stable, level, and horizontal surface.
- Leave at least 20cm free space behind and on both sides of the appliance and leave at least 30cm free space above the appliance.
- Do not place anything on top of the appliance.
- Do not sit or stand on the appliance. Sitting or standing on the appliance may lead to potential injury.
- Do not place the appliance directly below an air conditioner to prevent condensation from dripping onto the appliance.
- Make sure all filters are properly installed before you switch on the appliance.
- Only use the original Philips filters specially intended for this appliance. Do not use any other filters.
- Combustion of the filter may cause irreversible human hazard and/or jeopardize other lives. Do not use the filter as fuel or for similar purpose.
- Avoid knocking against the appliance (the air inlet and outlet in particular) with hard objects.
- Always lift or move the appliance by the handle on back side of the appliance.
- Do not insert your fingers or objects into the air outlet or the air inlet to prevent physical injury or malfunctioning of the appliance.

- Do not use this appliance when you have used indoor smoke-type insect repellents or in places with oily residues, burning incense, or chemical fumes.
- Do not use the appliance near gas appliances, heating devices or fireplaces.
- Always unplug the appliance after use and before cleaning, or carrying out other maintenance or replacing the filters.
- Do not use the appliance in a room with major temperature changes, as this may cause condensation inside the appliance.
- To prevent interference, place the appliance at least 2 meters away from electrical appliances that use airborne radio waves such as TVs, radios, and radio-controlled clocks.
- The appliance is only intended for household use under normal operating conditions.
- Do not use the appliance in wet surroundings or in surroundings with high ambient temperatures, such as the bathroom, toilet, or kitchen.
- The appliance does not remove carbon monoxide (CO) or radon (Rn). It cannot be used as a safety device in case of accidents with combustion processes and hazardous chemicals.
- If you need to move the appliance, disconnect the appliance from the power supply first.
- Do not move the appliance by pulling its power cord.
- Always wash your hands thoroughly after changing or cleaning a filter.
- Always keep the particle sensor cover closed during the application.

2 Your air purifier

Congratulations on your purchase, and welcome to Philips!

To fully benefit from the support that Philips offers, register your product at www.philips.com/welcome.

Product overview

- A Control panel
- B Air quality light
- C Air outlet
- D Air quality sensor
- E NanoProtect filter HEPA Series 3 (FY1410)
- F NanoProtect filter Active Carbon (FY1413)
- G Pre-filter
- H Air inlet
- I Front panel

Controls overview

- A On/Off button
- B Night sensing mode button
- C Display screen
- D Fan speed button
- E Child lock button

3 Getting started

Installing the filter

Note

- Make sure the air purifier is unplugged from the electrical outlet before installing the filter.
- Make sure the side of the filter with the tag is pointing towards you.

- 1 Pull the bottom part of the front panel and then gently lift to remove it from the air purifier (Fig.③).
- 2 Press the clip down (1) and pull the pre-filter towards you (2) (Fig.④).
- 3 Take out all filters (Fig.⑤).
- 4 Remove all packaging materials from the filter (Fig.⑥).
- 5 Place the thick filter (**FY1410**) into the air purifier and then the thin AC filter (**FY1413**) (Fig.⑦). The model numbers are shown on each filter.
- 6 Attach the pre-filter back into the air purifier (Fig.⑧).

Note

- Make sure the side with the clip is pointing towards you, and that all hooks of the pre-filter are properly attached to the purifier.

- 7 Reattach the front panel by pressing the top part of the panel onto the top of the air purifier (1). Then, gently push the panel against the body of the air purifier (2) (Fig.⑨).
- 8 Wash your hands thoroughly after installing filters.

4 Using the air purifier

Understanding the air quality light

Air quality light color	Air quality level
Blue	Good
Blue-purple	Fair
Purple-red	Poor
Red	Very Poor

The air quality light automatically goes on when the air purifier is switched on, and lights up all colors in sequence. After approximately 30 seconds, the air quality sensors select the color that corresponds to the surrounding air quality of airborne particles.

Turning on and off

Note

- Always place the air purifier on a stable, horizontal, and level surface with the front of the unit facing away from walls or furniture.
- For optimum purification performance, close doors and windows.
- Keep curtains away from the air inlet or air outlet.

- 1 Put the plug of the air purifier in the power socket.

2 Touch  to switch on the air purifier (Fig. .

- ↳ The air purifier beeps.
- ↳ The air purifier operates under the auto purification mode by default.
- ↳ After measuring the air quality for approximately 30 seconds, the air quality sensor automatically selects the appropriate air quality light color.

3 Touch  for 3 seconds to switch off the air purifier.

Note

- If the air purifier stays connected to the electrical outlet after turning OFF, the air purifier will operate under the previous settings when turned ON again.
- If the air purifier accidentally shuts off during running, it restarts automatically and operates under previous settings when the power supply is resumed.

Changing the fan speed

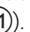

There are several fan speeds available. You can choose the auto purification mode (A), speed 1, 2, 3 or turbo mode (t).

Auto (A)

- Touch the fan speed button  repeatedly to select the auto purification mode (Fig. .

Allergen mode

The specially designed allergen mode can effectively reduce common allergens such as pollen and pet dander.

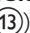

- Touch the fan speed button  to select the Allergen mode (Fig. .
- ↳ Auto (A) and  display on the screen.

Manual

- Touch the fan speed button  repeatedly to select the fan speed you need (Fig. .

Turbo (t)

In turbo mode, the air purifier operates on the highest speed.

- Touch the fan speed button  to select the turbo mode (t) (Fig. .

Light sensor

With the light sensor, the air purifier can work according to the ambient light.

When the ambient light dims for 10 seconds, all the lights on the control panel will be off slowly. During this period, you can touch any of the buttons, all lights will be on again. If you don't perform other operations within 10 seconds, all lights will be off.

After the ambient light becomes bright and lasts at least for 10 seconds, all lights will be on again.

Night sensing mode

You can activate the night sensing mode in two ways.



Activating the night sensing mode manually

- Before you go to sleep, touch  manually to activate the night sensing mode (Fig. 15).
 - ↳ If the air quality light is blue, the air purifier directly goes to the night sensing mode. The air purifier operates quietly and the air quality light will be dimmed.
 - ↳ If the air quality light is not blue, the air purifier operates under turbo mode for a maximum of 10 minutes, the air quality light blinks slow during this time, and then goes to the night sensing mode.





Auto activating the night sensing mode

When the air purifier operates in auto purification mode or allergen mode, if the light sensor detects the lights in your room are turned off, the air purifier goes to the night sensing mode automatically. The air purifier will adjust the fan speed in real-time to make sure the air in your room is clean. The air quality light will be dimmed.

Note

- The light sensor detects the lights in your room after 11 hours in the night sensing mode.
- If the lights in your room are turned on, the air purifier will quit the night sensing mode and operate under the previous mode. The air quality light and the display will be on again.
- To exit the night sensing mode manually, touch  or  button.

Set the child lock

- 1 Touch the child lock button  for 3 seconds to activate child lock (Fig. 16).
 - ↳ The child lock icon  displays on the screen.
 - ↳ When the child lock is on, all the other buttons are not responsive, only the child lock icon  blinks.
- 2 Touch the child lock button  for 3 seconds again to deactivate child lock (Fig. 17).
 - ↳ The child lock icon  disappears.

Note

- The child lock function is automatically unlocked when the pre-filter cleaning code or the filter replacement code displays on the screen.

5 Cleaning



Note

- Always turn the air purifier off and unplug the air purifier from the electrical outlet before cleaning.
- Never immerse the air purifier in water or any other liquid.
- Never use abrasive, aggressive, or flammable cleaning agents such as bleach or alcohol to clean any part of the air purifier.
- Only the pre-filter is washable. The air filter is not washable.
- Do not attempt to clean the filters or air quality sensor with a vacuum.

Cleaning the body of the air purifier

Regularly clean the inside and outside of the air purifier to prevent dust from collecting.

- 1 Use a soft, dry cloth to clean both the interior and exterior of the air purifier (Especially for the front cover).
- 2 The air outlet can also be cleaned with a dry, soft cloth.
- 3 Detach the front cover from the air purifier and wash it under running tap water.

Cleaning the air quality sensor

Clean the air quality sensor every 2 months for optimal functioning of the purifier.



Note

- If the air purifier is used in a dusty environment, it may need to be cleaned more often.
- If the humidity level in the room is very high, condensation may develop on the air quality sensor and the air quality light may indicate a more poor air quality even though the air quality is actually good. If this occurs, clean the air quality sensor or use the air purifier on a manual speed setting.

- 1 Switch off the air purifier and unplug from the power socket.
- 2 Clean the air quality sensor inlet and outlet with a soft brush (Fig. 18).
- 3 Remove the air quality sensor cover (Fig. 19).
- 4 Clean the air quality sensor, the dust inlet and the dust outlet with a damp cotton swab (Fig. 20).
- 5 Dry all parts thoroughly with a dry cotton swab.
- 6 Reattach the air quality sensor cover (Fig. 21).



Note

- Always keep air quality sensor cover close during the air purifier is working.

Cleaning the pre-filter

Clean the pre-filter when **F0** is displayed on the screen (Fig. 22).

- 1 Switch off the air purifier and unplug from the power socket.
- 2 Pull the bottom part of the front panel and then gently lift to remove it from the air purifier (Fig. 3).
- 3 Press the clip down (1) and pull the pre-filter towards you (2) (Fig. 4).
- 4 If the pre-filter is very dirty, use a soft brush to brush away the dust. Then wash the pre-filter under running tap water (Fig. 23).
- 5 Allow the pre-filter to air dry thoroughly before placing back in the air purifier.



Note

- To optimize the lifetime of the pre-filter, make sure it dries completely after cleaning.
- Wash your hands after handling the filter.

- 6 Put the pre-filter back into the air purifier (Fig. 8).



Note

- Make sure the side with the clip is pointing towards you, and that all hooks of the pre-filter are properly attached to the air purifier.

- 7 To reattach the front panel, press the top part of the panel onto the top of the air purifier (1). Then, gently push the panel against the body of the air purifier (2) (Fig. 9).
- 8 Put the plug of the air purifier in the electrical outlet.
- 9 Touch the  for 3 seconds to reset the pre-filter cleaning time (Fig. 24).
- 10 Wash your hands thoroughly after installing filters.

6 Replacing the filter

Filter replacement indicator

This air purifier is equipped with a filter replacement indicator to make sure that the air purification filter is in optimal condition when the air purifier is operating. When the filters need to be replaced, the filter code displays on the screen.

If the filters are not replaced in 14 days, the air purifier will stop operating and automatically lock.

Replacing the filters

Note

- The air filters are not washable or reusable.
- Always turn off the air purifier and unplug from the electrical outlet before replacing the filters.
- Do not clean the filter with a vacuum.

Filter alert light status	Action
A3 displays on the screen	Replace NanoProtect filter HEPA Series 3 (FY1410)
C7 displays on the screen	Replace the NanoProtect filter Active Carbon (FY1413)
A3 and C7 display on the screen alternately	Replace both filters

- 1 Turn off the air purifier and unplug from the power socket.
- 2 Take out the used air filter according to the filter alert light status displayed on the screen (Fig. 25). Discard used filter.

Note

- Do not touch the pleated filter surface, or smell the filter as it has collected pollutants from the air.

- 3 Remove all packaging material from the new filter (Fig. 6).
- 4 Place the new filters into the air purifier (Fig. 7).
- 5 Put the plug of the air purifier in the power socket.
- 6 Touch the  for 3 seconds to reset the filter lifetime counter (Fig. 26).
- 7 Wash your hands after changing a filter.



7 Storage

- 1 Turn off the air purifier and unplug from the power socket.
- 2 Clean the air purifier, air quality sensor and pre-filter (see chapter 'Cleaning').
- 3 Let all parts dry thoroughly before storing.
- 4 Wrap the filter and pre-filter separately in air tight plastic bags.
- 5 Store the air purifier, the filter and pre-filter in a cool, dry location.
- 6 Always thoroughly wash hands after handling filters.

8 Troubleshooting

This chapter summarizes the most common problems you could encounter with the air purifier. If you are unable to solve the problem with the information below, visit www.philips.com/support or contact the Consumer Care Center in your country.

Problem	Possible solution
The air purifier does not work even though it is plugged in to the power socket and switched on.	<ul style="list-style-type: none">• Try a different electrical outlet or check the wall switch.• The filter alert status is displaying the filter code. Replace the corresponding filter and reset the filter lifetime counter (see chapter "Replacing the filter").• If the problem persists, contact the Consumer Care Center in your country.
The air purifier does not work even though it is switched on.	<ul style="list-style-type: none">• The filter replacement indicator has been on continuously but you have not replaced the corresponding filter, and the air purifier is now locked. In this case, replace the filter and reset the filter lifetime counter.
The air purifier accidentally powers off.	<ul style="list-style-type: none">• The air purifier restarts automatically and goes to the previous mode when the power resumes.
The airflow that comes out of the air outlet is significantly weaker than before.	<ul style="list-style-type: none">• The pre-filter is dirty. Clean the pre-filter (see chapter "Cleaning").
The air quality does not improve, even though the air purifier has been operating for a long time.	<ul style="list-style-type: none">• One of the filters has not been placed in the air purifier or the filter is not placed properly. Make sure that all filters are properly installed in the following order, starting with the innermost filter: 1) NanoProtect filter HEPA Series 3 (FY1410); 2) NanoProtect filter Active Carbon (FY1413) 3) pre-filter The air quality sensor is wet. Make sure that the air quality sensor is clean and dry (see chapter "Cleaning").
The color of the air quality light always stays the same.	<ul style="list-style-type: none">• The air quality sensor is dirty. Clean the air quality sensor (see chapter "Cleaning").

Problem	Possible solution
The air purifier produces a unpleasant smell.	<ul style="list-style-type: none"> The first few times you use the air purifier, it may produce a plastic smell. This is normal. The air purifier may also produce an unpleasant smell when the filter is dirty. In this case, clean or replace the appropriate filter. However, if the appliance produces a burnt smell even if removing filters, contact your Philips dealer or an authorized Philips service center.
The air purifier is loud.	<ul style="list-style-type: none"> If the air purifier is too loud, change the fan speed to a lower fan speed level. When using the air purifier in a bedroom at night, choose the night sensing mode or select a lower fan speed level.
The air purifier still indicates that I need to replace a filter, but I already did.	<ul style="list-style-type: none"> Perhaps you did not reset the filter lifetime counter. Plug in the air purifier, touch  to switch on the air purifier, and touch the  for 3 seconds.
Error codes "E1", "E2", "E3" or "E4" displays on the screen.	<ul style="list-style-type: none"> The air purifier has malfunctions. Contact the Consumer Care Center in your country.

9 Guarantee and service

If you need information or if you have a problem, please visit the Philips website at www.philips.com or contact the Philips Consumer Care Center in your country (you find its phone number in the worldwide guarantee leaflet). If there is no Consumer Care Centre in your country, go to your local Philips dealer.

Order parts or accessories

If you have to replace a part or want to purchase an additional part, go to your Philips dealer or visit www.philips.com/support.

If you have problems obtaining the parts, please contact the Philips Consumer Care Center in your country (you can find its phone number in the worldwide guarantee leaflet).

10 Notices

Electromagnetic fields (EMF)

This Philips appliance complies with all applicable standards and regulations regarding exposure to electromagnetic fields.

Compliance with EMF

Philips Domestic Appliances Holding B.V. manufactures and sells many products targeted at consumers, which, like any electronic apparatus, in general have the ability to emit and receive electromagnetic signals.

One of Philips' leading Business Principles is to take all necessary health and safety measures for our products, to comply with all applicable legal requirements and to stay well within the EMF standards applicable at the time of producing the products.

Philips is committed to develop, produce and market products that cause no adverse health effects. Philips confirms that if its products are handled properly for their intended use, they are safe to use according to scientific evidence available today.

Philips plays an active role in the development of international EMF and safety standards, enabling Philips to anticipate further developments in standardization for early integration in its products.

Recycling

Do not throw away the product with the normal household waste at the end of its life, but hand it in at an official collection point for recycling. By doing this, you help to preserve the environment.

Follow your country's rules for the separate collection of electrical and electronic products. Correct disposal helps prevent negative consequences for the environment and human health.