

Preethi

KITCHEN HOOD



WARRANTY CARD

Date of Purchase _____

Dealer's name _____

Customers name and address _____

Email id _____

Alternate contact no. _____

Model No. _____

Dealer's signature _____

Dealers stamp _____

Product serial number

FUTURA TECH PARK Q4, 4TH FLOOR, BLOCK B, #334, RAJIV GANDHI SALAI,
(OMR) SHOLINGANALLUR, CHENNAI- 600119. TAMIL NADU. INDIA

PHONE: +91 44 2450 1042, +91 442450 1044 EMAIL: INFO@PREETHI.IN
WEBSITE: www.preethi.in

2 YEAR PRODUCT WARRANTY | **10 YEAR** MOTOR WARRANTY | **LIFELONG** FREE SERVICE | **FIRST YEAR** 3 DEEP CLEANING FREE | **FREE** INSTALLATION

Disclaimer-

Lifelong free service is applicable only for warranty issues & not meant for cleaning & installation services
##Maximum of 3 deep cleaning service upon registration, to be availed within 1 year of installation
##Missed deep cleaning services can't be encashed or carried forward for the subsequent years

The Manager - Customer Care (Preethi Brand)
Philips Domestic Appliances India Ltd.
Futura Tech Park Q4, 4th Floor, Block B,
#334 Rajiv Gandhi Salai, (OMT) Sholinganallur,
Chennai - 600119. Tamil Nadu. India.

Phone: +91 44 2450 1042, +91 442450 1044
Email: Info@preethi.in, Website: www.preethi.in

Preethi

KITCHEN HOOD

KH211

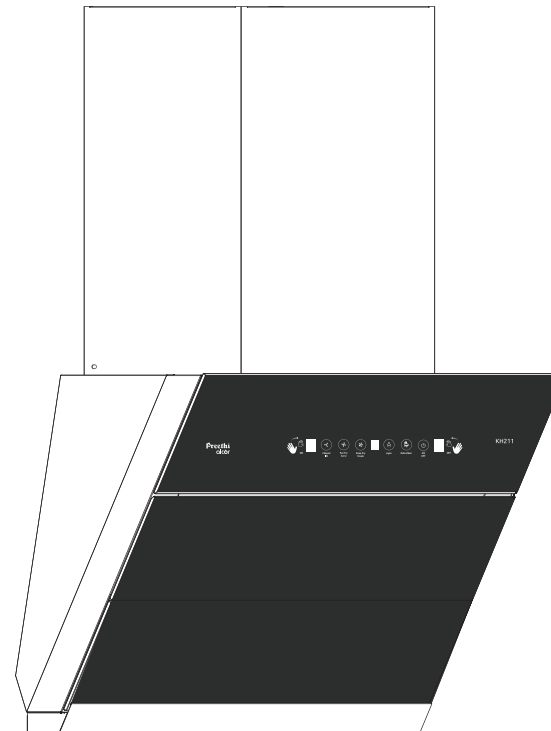

KITCHEN HOOD USER MANUAL

Please read guidelines provided in this user manual on important instructions, appliance usage and warranty before using the product.

Our Values and Mission

Every product that bears the PREETHI brand name has to pass a series of stringent quality tests.

Preethi, relies on its core values of **performance, quality, reliability and safety.**

Our mission remains single-minded:

to improve the family's quality of life through the superior quality and efficiency of our home appliances.

Cleaning- Terms and Conditions

1. Applicable only on product registered and installed by Preethi i.e. three deep cleaning service within the first year from the date of installation.
2. Customer cannot avail the free deep cleaning service in case of installation carried by any third party.
3. Preethi will not be liable for any damages existing in the product before the cleaning.
4. Deep cleaning includes only filter, body assembly, chimney cover, air outlet & non return flap, inner body, blower & motor housing.
5. The service is not-transferable
6. Any change of address shall be communicated to Preethi through mail id " care@preethi.in" or one call assistance. Service at the change of location is subject to the availability of Preethi service. Preethi's decision on the location would be final.
7. All dispute shall be subject to the exclusive jurisdiction of Chennai.
8. Three times deep cleaning free service cannot be exchanged for cash or discount on product.

Cleaning- Terms and Conditions

1. Applicable only on product registered and installed by Preethi i.e. three deep cleaning service within the first year from the date of installation.
2. Customer cannot avail the free deep cleaning service in case of installation carried by any third party.
3. Preethi will not be liable for any damages existing in the product before the cleaning.
4. Deep cleaning includes only filter, body assembly, chimney cover, air outlet & non return flap, inner body, blower & motor housing.
5. The service is not-transferable
6. Any change of address shall be communicated to Preethi through mail id " care@preethi.in" or one call assistance. Service at the change of location is subject to the availability of Preethi service. Preethi's decision on the location would be final.
7. All dispute shall be subject to the exclusive jurisdiction of Chennai.
8. Three times deep cleaning free service cannot be exchanged for cash or discount on product.

Cleaning- Terms and Conditions

1. Applicable only on product registered and installed by Preethi i.e. three deep cleaning service within the first year from the date of installation.
2. Customer cannot avail the free deep cleaning service in case of installation carried by any third party.
3. Preethi will not be liable for any damages existing in the product before the cleaning.
4. Deep cleaning includes only filter, body assembly, chimney cover, air outlet & non return flap, inner body, blower & motor housing.
5. The service is not-transferable
6. Any change of address shall be communicated to Preethi through mail id " care@preethi.in" or one call assistance. Service at the change of location is subject to the availability of Preethi service. Preethi's decision on the location would be final.
7. All dispute shall be subject to the exclusive jurisdiction of Chennai.
8. Three times deep cleaning free service cannot be exchanged for cash or discount on product.

Welcome to the Preethi Family!

Congratulations on the purchase of your Preethi Kitchen Hood. Trusted quality, meaningful innovation, and undisputed service have made Preethi the preferred brand of more than 15 million consumers. Throughout our 41+ years, we have continuously reinvented the industry to customize and design innovations for Indian consumers, thereby improving the experience of working in the kitchen. Preethi Kitchen Hoods are here to make every day cooking convenient, efficient and enjoyable!

Every new feature of the Preethi Kitchen Hood is the outcome of intensive research and continuous consumer engagements. Our expert team has identified the key insights, which has helped in our endeavor to provide customers with a smoke-free and hassle-free cooking experience.

To ensure maximum usage, for the first time in the industry our brand co-owns your product for the initial year for a stress-free onboarding journey. Every Kitchen Hood comes with a bouquet of gifts – free installation by our trained dedicated service engineers (including the full-length aluminum duct), three deep cleaning services (within the first year), 2 years product warranty and 10 years motor warranty applicable on product registration.

To know and understand more about the product – functionality, usage and cleaning, please visit our website www.preethi.in.

Wishing you a pleasant experience with your Preethi Kitchen Hood!



Preethi commitment to quality begins with product design and continues throughout the entire value chain. We focus on end-to-end quality, from the sourcing of material to delivery.

Every Preethi product is designed, manufactured and delivered knowing that consumers and their families are counting on quality. From material sourcing and selection through product testing and monitoring, we employ a quality-first philosophy that supports compliance with International regulations and standards to provide the best value for consumers.



Motor endurance test[^]

Robust motor tested for 3000 hrs of running



User interface reliability test[^]

Touch control panel tested for 5000 times



Motion interface reliability test[^]

Motion control panel tested for 5000 times



Auto cleaning test[^]

Robust auto cleaning function tested for 100hrs of running



Corrosion resistant test[^]

Continuously tested for 72hrs to prevent corrosion



Reliability test[^]

Built to withstand 500 hours of continuous running of oil & smoke



IEC compliant

Product tested for IEC 60335-2-31 Safety Standard



RoHS Compliant

Made of eco-friendly materials to ensure good health & safety



Electromagnetic compatibility

Reduces High frequency electronic noise & prevents electronic interference with other devices



Electrical strength test[^]

Tested for up to 1000Volts

[^]based on internal testing standards

Preethi

1st Free Deep Cleaning Service

Coupon No. _____

Model No. _____

Serviced on _____

Servicing stamp & signature

Coupon No. _____

Model No. _____

Serial No. _____

Date of sale _____

Serviced on _____

Technician signature _____

Customer signature _____

Servicing stamp

Preethi

2nd Free Deep Cleaning Service

Coupon No. _____

Model No. _____

Serviced on _____

Servicing stamp & signature

Coupon No. _____

Model No. _____

Serial No. _____

Date of sale _____

Serviced on _____

Technician signature _____

Customer signature _____

Servicing stamp

Preethi

3rd Free Deep Cleaning Service

Coupon No. _____

Model No. _____

Serviced on _____

Servicing stamp & signature

Coupon No. _____

Model No. _____

Serial No. _____

Date of sale _____

Serviced on _____

Technician signature _____

Customer signature _____

Servicing stamp

11. Troubleshooting guide

If any abnormal phenomenon occurs during range hood working, please stop using and unplug power supply and check the faults. Only professionals should dismantle the hood. The common faults and diagnosis are as follows

Fault	Reason	Solution
Lamp is not on. Motor is running	Poor wire connection	Repair or change wires
	Lamp is damaged	Change lamp
	Poor connect between lamp and socket	Repair or change
	The quartz lamp transformer burning out	Contact customer center
Lamp is not on. Motor is not running	Poor connect between plug and socket	Repair or change
	Power cord break	Change power cord
	Fuse of power board breaks	Change fuse
Lamp is on. Motor is not running	Condenser burns	Change condenser
	Motor burns	Change motor
	Faults of power board and control board	Contact customer center
Violent vibration, noise increases	Check the hanging is strong enough	Hanging range hood family
	The connecting pieces of the fixed screws are loose	Tighten screws
	Volute standing fixed screw are loose	Tighten screws
	Motor fixed screws are loose	Tighten screws
	Impeller installation is not in place	Install in place
Poor suction	Impeller is damaged and balance piece is lost	Change impeller
	Too much air on filter	Clean filter
	The air convection in the kitchen is too big or space sealing is too tight	Reduce air convection and open doors and windows moderately
	Higher installation height	Adjust to appropriate height
	Exhaust pipe is too long or too more turns	Install according to the manual
Auto cleaning not working	Outdoor wind is too strong	Non technical faults
	Faults of power board and control board	Contact customer center

12. Cleaning- Terms and Conditions

1. Applicable only on product registered and installed by Preethi i.e. three deep cleaning service within the first year from the date of installation.
2. Customer cannot avail the free deep cleaning service in case of installation carried by any third party.
3. Preethi will not be liable for any damages existing in the product before the cleaning.
4. Deep cleaning includes only filter, body assembly, chimney cover, air outlet & non return flap, inner body, blower & motor housing.
5. The service is not-transferable.
6. Any change of address shall be communicated to Preethi through mail id "care@preethi.in" or one call assistance. Service at the change of location is subject to the availability of Preethi service. Preethi's decision on the location would be final.
7. All dispute shall be subject to the exclusive jurisdiction of Chennai.
8. Three times deep cleaning free service cannot be exchanged for cash or discount on product.

Index

1. Introduction.....	4
2. General Description.....	4
3. Before using the chimney.....	5
4. Attention.....	5
5. Warning.....	7
6. Control Panel.....	7
7. Operation.....	8
8. Maintenance.....	8
9. Preethi @home service assistance.....	9
10. WARRANTY - Terms and conditions.....	10
11. Troubleshooting guide.....	12
12. Cleaning - Terms and conditions.....	12
13. Warranty Card.....	14

1. Introduction

Preethi brings to you complete range of Kitchen hoods

Technical specification*

Model Name	Alcor
Model name	KH211
Rated input	220V-240V, 50 Hz
Motor watts	200W
Chmney size	60cm
Body finish	Black
Suction (m3/hr)	1200
Auto cleaning	Yes
Type	Wall mounted
Speed level	3 speed touch & motion
Filter	1 x filter with anti grease coating
LED light	2 x 1.5 lamps
Oil collector	Yes

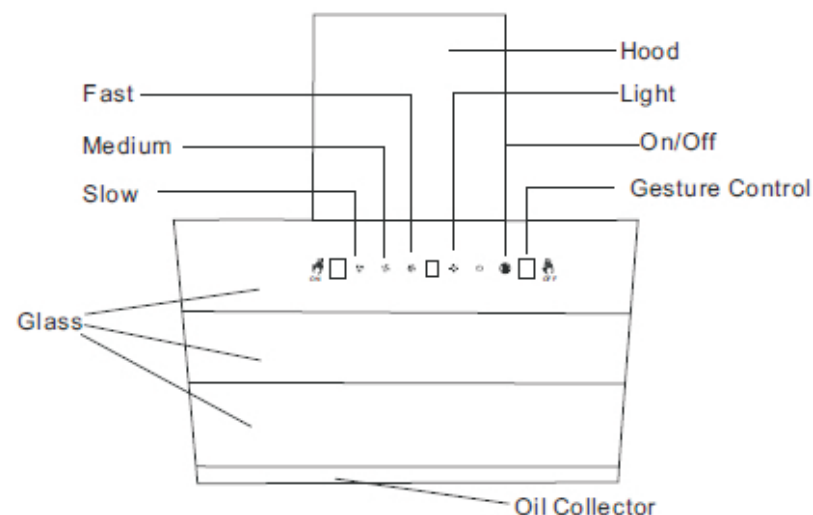

9. Preethi @home service assistance

Before calling the one call assistance to register the complaint:

* Check the 'Trouble Shooting Guide' (refer point 11) given above to see if you can eliminate the problem yourself

* Re-start the chimney to check if correct operation is restored

Please do not allow any unauthorized person to service or repair the chimney. This may affect the safety and quality of the product. This will also make the Warranty null and void. Please call Preethi on 9940000005 (One call assistance), for any product queries or service escalations

10. WARRANTY - Terms and conditions

The warranty is extended only in case of defects in manufacturing and/or workmanship. Preethi undertakes to replace/ repair, at its sole discretion if parts except bulbs, glass parts, pest control device, battery, anti-grease coating on filter and other accessories items are found to have manufacturing defects on inspection by Preethi. The warranty is 2 years on product which includes PCB, push button, Rotor & 10 years on motor. This warranty is subject to the terms and conditions mentioned below:

1. To avail warranty services, it is mandatory for the products to be installed by Preethi @home service assistance. While installation Preethi @home service assistant expert will perform the registration of the product by verifying bill/invoice
2. Warranty will not be valid for installation done by other than Preethi @home assistance service
3. Only functional parts Motor, PCB, Push button and Rotor are covered under this warranty. Warranty does not cover consumables, Physical damages and wear & tear parts- Bulbs, Switches / Knobs, outer body, metal / Glass / plastic parts, Filter locks, pest control device, battery, anti-grease coating on filter and other accessories items of the chimneys
4. All routine maintenance/ cleaning are not covered under warranty, and are provided on chargeable basis as per prevailing charges
5. This appliance is designed only for domestic use by private individuals at home only. Warranty is not applicable for commercial use of product
6. It is mandatory to get the product serviced/ cleaned at least 4 times a year by calling one call

Preventive Maintenance Contract (PMC) for trouble free operation by company authorized service centres

7. The warranty becomes null and void in following cases:

- Installation/ service/ repairs/ modification carried out by persons other than those authorized by Preethi
- Failure due to non-genuine parts
- Removal, alteration or tampering of serial no. of chimney and its components
- Damages occurred due to improper external electric circuits and failure due to erratic power supply
- Damage resulting to the chimney due to operation in an abnormally corrosive alkaline, acidic atmosphere or use of harmful chemicals
- Failure due to misuse/ negligence/ accident/ action of pests, rodents / or act of god / lightning /fire/flood/ earthquake due to electrical short circuit
- Appliance taken out of country

8. Preethi undertakes no liability in the matter of consequential loss and/ or damages caused to the customer or third party due to failure / malfunction of the chimney. Preethi's obligation under this warranty shall be limited to repairing or replacing the defective parts only

9. Whether defective item or components are to be replaced/ repaired shall be left to the sole discretion of Preethi. In case of replacement of a part, the defective part becomes the property of Preethi

10. In case no authorized service centre is present in the area/ or in case service is to be provided beyond municipal/city limits, then services would be provided from the nearest authorized service area, a fixed charge would be applied (subject to distance) in addition to the actual to & fro charges along with local conveyance by the shortest route. However, in order to avail the services, the products could also be brought at the nearest authorized service centre by the customer at their own expense

11. In case of change of location from the original place of purchase at any given point in time, register a request with Preethi one call assistance for reinstallation. Prevailing rates will be applicable at that point of time

12. Services would be provided within normal working hours (0900 to 1830 hrs) on regular working days except Sundays & public holidays

13. The decision of Preethi with regards to the settlement of all claims under this warranty shall be final

14. Any disputes arising are subject to court of Chennai jurisdiction only

7. Operation

Turn on and Turn off

For touch operation, once you connect the power chord, the entire light glows and then light goes off. Then, touch the "on/off" button, the glass will open & selected speed control to start the chimney.

For motion operation, once you connect the power chord, the entire light glows and then light goes off. Then, to start the chimney, place the hands up in front of sensor(5-10cm) and move from left to right. To turn off the chimney, place the hands up in front of sensor(5-10cm) and move from right to left repeat the same in 2times.

Motion control

Place the hand up in front of the sensor area, distance should be 5-10cm, then starts to control the chimney by hand motion. From left to right: Chimney will start operating on chapatti/Idli, light will be turned on.

Repeat same motion: Chimney will switch to pan fry/curry and deep fry/steam
From right to left: Chimney will start operating on delay mode.

Speed control

Press respective speed buttons (Chapati/Idli; Pan Fry/ Curry; Deep Fry/steam to start chimney working in corresponding speed. On selection of speed, respective speed button light glows.

The same can also operate by motion control, move your hand from left to right only.

Light control

Once power supply connected, "Light" button is effective in any working mode. Press "Light" to turn on LED lamp and press again to turn off the lamp.

Delay

A unique "Delay" shut-off function has been provided. Once the cooking is over, there are still some post cooking fumes remaining in the kitchen. In order to exhaust these fumes, the user has to keep on standing in the kitchen and wait for the fumes to get exhausted and then switch off the chimney. In order to eliminate this inconvenience faced by customer. Once the cooking is over, instead of switch off the product touch the "on/off" or places hand up in front of the sensor(5-10cm) area and move from right to left. A reverse timer of 3 min will get activated and the chimney will shut itself off after end of 3min. Keeping your kitchen fresh and hygienic as ever.

Auto clean

Press "Auto clean" buttons, A reverse timer of 9min will get activated (start blinking), after the heating pad works for 9 minutes, the blower will automatically start operating and most of the grease present within the cooker hood will get evaporated and blown out of the air-outlet. Any remaining grease will get drained out into the oil collector tray, located at the bottom of the filter. The "Auto clean" function will stop operating at the end of 9min. Wait for a moment and then carefully remove the oil collector ensure that you do not spill the grease

8. Maintenance

Regular maintenance and cleaning will ensure long life and great performance of the kitchen hood.

Cleaning of hood

- Unplug the electric supply when cleaning the hood
- Use damp cloth and mild liquid household cleaner
- Do not use wet cloth / sponge / running water
- Do not use cleaners containing alcohol, they might damage exterior paint
- Do not use abrasive cleaning material when cleaning stainless steel surface
- Use auto cleaning function once 2-4 weeks its depends on the usage

Benefits of regular maintenance and cleaning

- Regular cleaning will improve the effectiveness of the chimney
- Helps reduce oil deposits on chimney
- Helps extend the life of the motor
- Do not use cleaners containing alcohol, they might damage exterior paint
- Do not use abrasive cleaning material when cleaning stainless steel surface

Warning:

- Wear rubber gloves while cleaning to prevent any injury

3. Before using the chimney

Read this user manual carefully before you use the appliance, and save the user manual for future reference.

- This appliance is not intended for use by person(children) with reduced physical, sensory, mental capabilities, lack of experience & knowledge unless they have been given supervision on instruction concerning use of the appliance by a person responsible for their safety.

- Children should be supervised to ensure that they don't play with the appliance.

- Keep the appliance and its cord out of reach of children.

- For any further queries, please call Preethi one call assistance at +91- 9940000005

- Lifelong free service is applicable only for warranty related issues & not meant for cleaning & installation services

4. Attention

- Ensure that the voltage corresponds with the recommended voltage of 220-240V, 50Hz of the chimney

- Connect the chimney to the electric supply with proper earthing

- When installed, the minimum gap between the chimney and the cooking appliance must be at least 35cm – 40cm

- Make sure the product installation is not connected to wires inside of wall to avoid shock

- Ensure that the wall has sufficient strength to support the weight of kitchen hood

- The distance between exhaust hole and air outlet on the wall shall be less than 1.5m. When installing the exhaust pipe, the air outlet shall not be too high

- Ensure to operate in well ventilated room.

- The air exhaust should not be exposed to burning gas or other fuels

- Wear rubber gloves while cleaning to prevent any injury.

- Exercise caution while cleaning impeller to prevent deformation of the impeller, failing to do so might cause noise & vibration

- Prevent water seepage into switches, motor, lamps and other electric components while cleaning

- Only authorized professionals should change internal wiring

- Never leave frying pans unattended during use as overheated oil may catch fire

- Before carrying out maintenance, unplug the chimney from electric supply

- Never use high naked flame under the chimney

- When using a gas hob underneath, never leave the burner hob uncovered while the chimney is in use or when the pans have been removed. burner "ON" when unattended/ not in use

4.1 Supply system

a) Installation

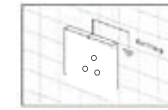

- Avoid contact with the steel and wires of wall inside in order to avoid electric shock

- The range hood must be properly earthed by connecting the 3 pin plug to a socket with earthing

- Check the electricity supply system in your home. It should meet the requirement of Range Hood's normal supply load

- Don't use high capacity fuse in electrical circuit and select correct ones as required on rating label

b) Preparation and Confirmation before Installation

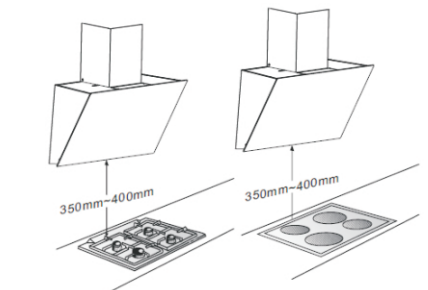

Wall Strength:

- The Wall that the Range Hood is placed must be strong enough to bear the weight of range hood

Height of Mounting:

- The suitable height of mounting shall be 350-400mm
- The real installation height is subject to the construction of kitchen and the user's height

c) Hanger Installation:

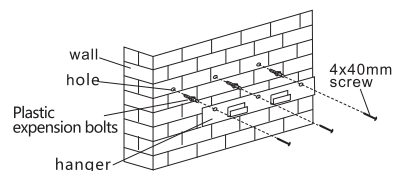

- Measure the installation height. Mark the position of the hanger on the wall
- Drill the holes for fixing hanger. Punch expansion bolts into the holes & fix the hanger
- Fix the air outlet on the exhaust hole of range hood with 4 Screws and 4 washers*
- The head of the exhaust pipe that is 150mm in diameter should then be inserted into the air outlet

d) Hood cover fixing

- Connect the hood and bracket with 2 piece 4*10mm screws. Then fix the hood on the top of the range hood

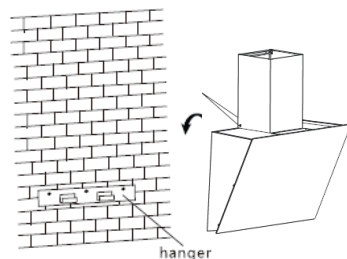
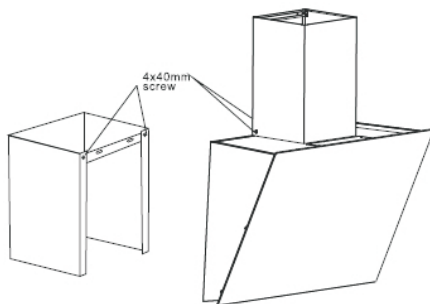

e) Product installation

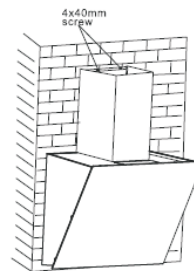

- Aim at the hooks and hang the range hood from the wall. Mark the position of hanger and two screws on the body
- Put down the range hood, drill holes on the marks as indicated in the picture. Insert expansion bolts in the holes. Hang up the range hood
- Fix hanger with screws
- Fix the product within the body with two screws. Connect the other end of exhaust pipe to the air outlet

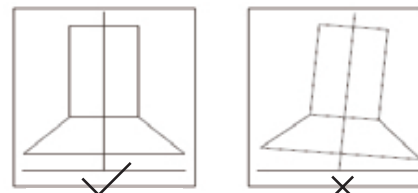

- NOTE: Make sure kitchen hood is parallel to the ground and is not tilted

f) Exhaust pipe connecting to the wall outside

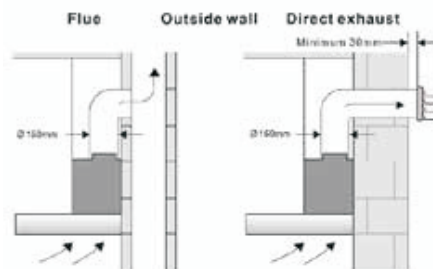

- Exhaust pipe should be connected to the flue or the hole of wall outside

g) Confirmation of Installation

- After installation, connect to power supply and turn on the range hood
- Check all the functions of range hood are working normally; there is no abnormal vibration and resistance to air outlet

5. Warnings

- * There is a fire risk if cleaning is not carried out in accordance with the instructions
- * CAUTION : Accessible parts may become hot when used for exhausting fumes from appliances burning gas or other fuels
- * CAUTION : Don't place your hand after switch off the chimney and during the period of glass closing.
- * The air must not be discharged into a flue that is used for exhausting fumes from appliances burning gas or other fuels
- The range hood is only intended to be installed over a hob with no more than four hob elements
- If the supply cord is damaged, it must be replaced by the Manufacturer, its service agent or similarly qualified persons in order to avoid a hazard.

6. Control panel

Button/Touch Illustration

- Chapati/Idli: Low speed
- Pan fry/curry: Med speed
- Deep fry: High speed
- Lamp: Turn on/off LED light
- Auto Clean: Auto cleaning function ON
- On/OFF: Turn on/off chimney
- Motion : left to right is turn ON the chimney; right to left is the turn OFF the chimney

i. Control image

